

# Genesis GF200 Balanced Regulator

## Disassembly



- 1) Make a note of which ports are plugged**
- 2) Make a note of which hoses go to which ports.**
- 3) Remove all hoses from the 1st stage body.**



4) Unscrew and remove the handwheel (item 2) and the dust cap (item 3).



- 5) **Install a regulator support handle into any low pressure port.**
- 6) **Use a 1" socket with extender and socket wrench to remove the yoke nut (item 5) and the yoke (item 4).**

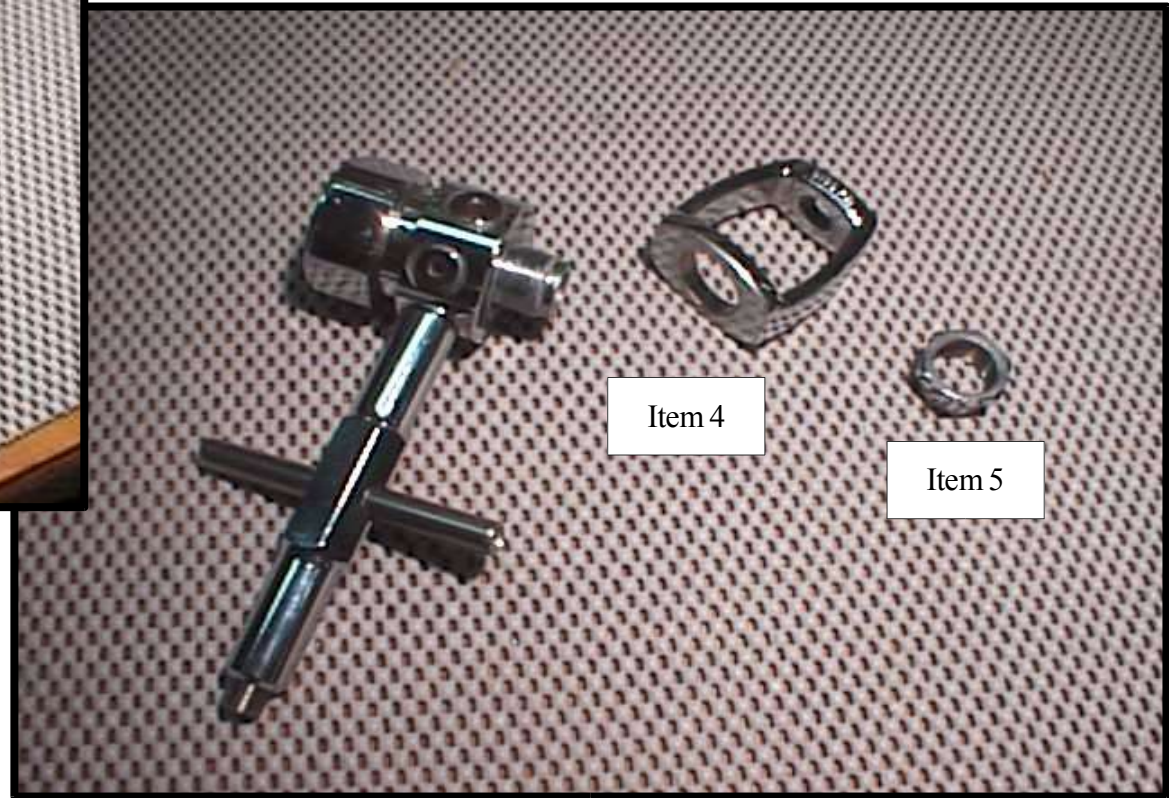



- 7) Use a 5/32" Allen wrench to remove all port plugs (items 14 & 16) from the body.
  - a. Remove o-rings from the port plugs.
  - b. Discard o-rings if worn or damaged.



**8) Use a 15" adjustable wrench or bench vise with protected jaws to remove the end cap (item 26).**



- 9) Remove the piston (item 24) from the regulator body.
- 10) Remove the spring (item 19) from the regulator body
- 11) Remove the shims (item 20) from the regulator body and piston

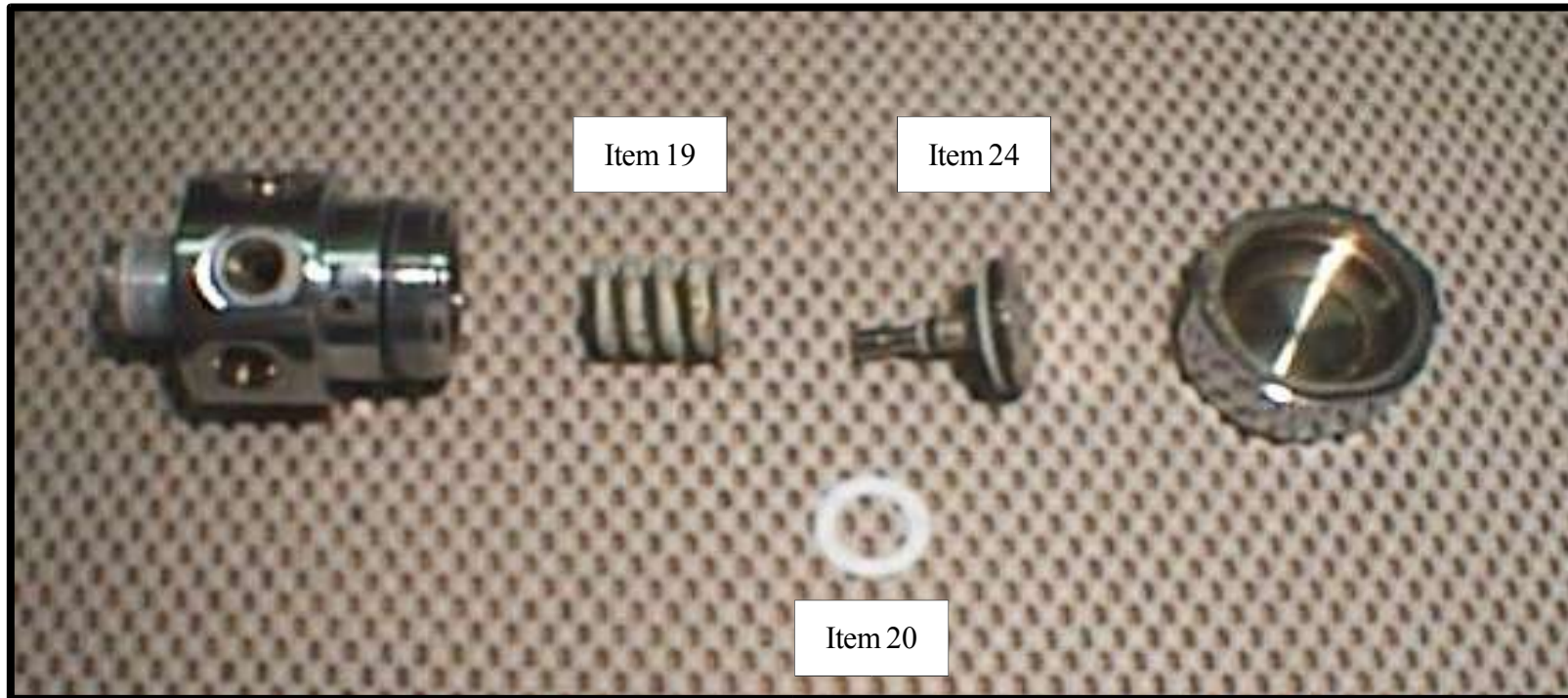

**12) Remove o-ring (item 18) from regulator body.**

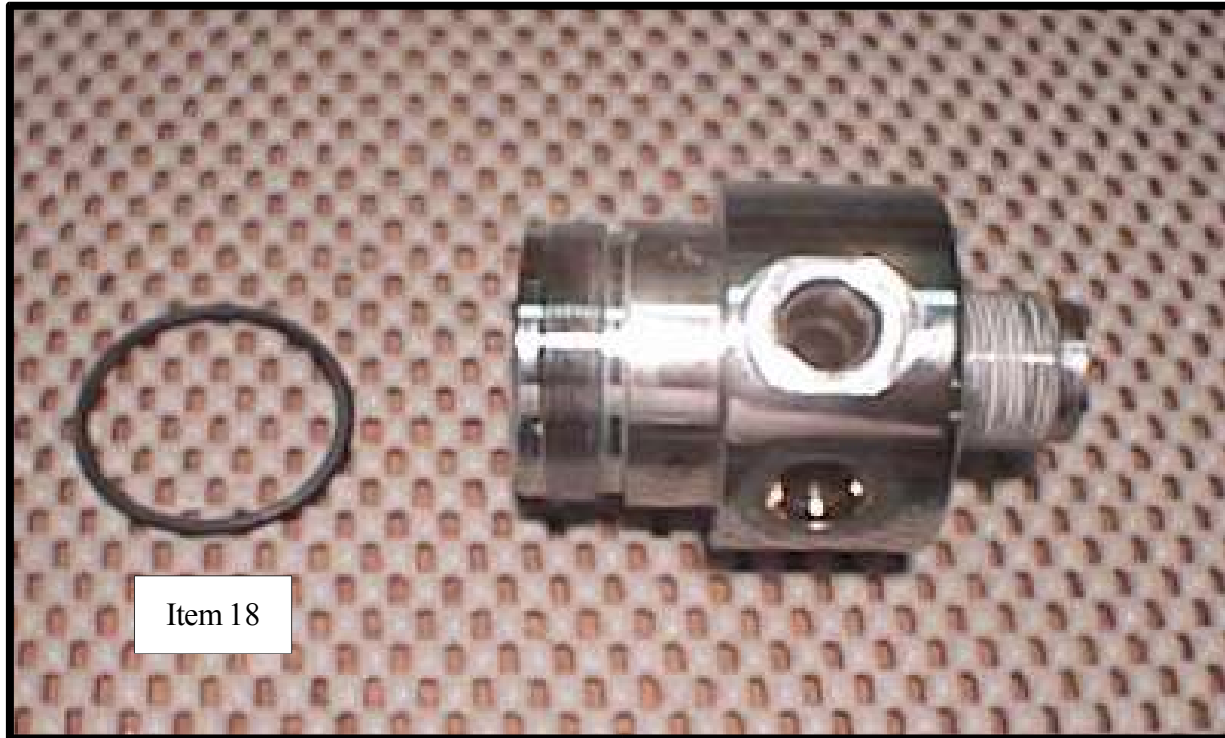

Item 18



- 13) Remove the o-rings (items 22 & 25) from the piston and discard.
- 14) Remove the backup rings (items 23 & 28) from the piston and set aside.

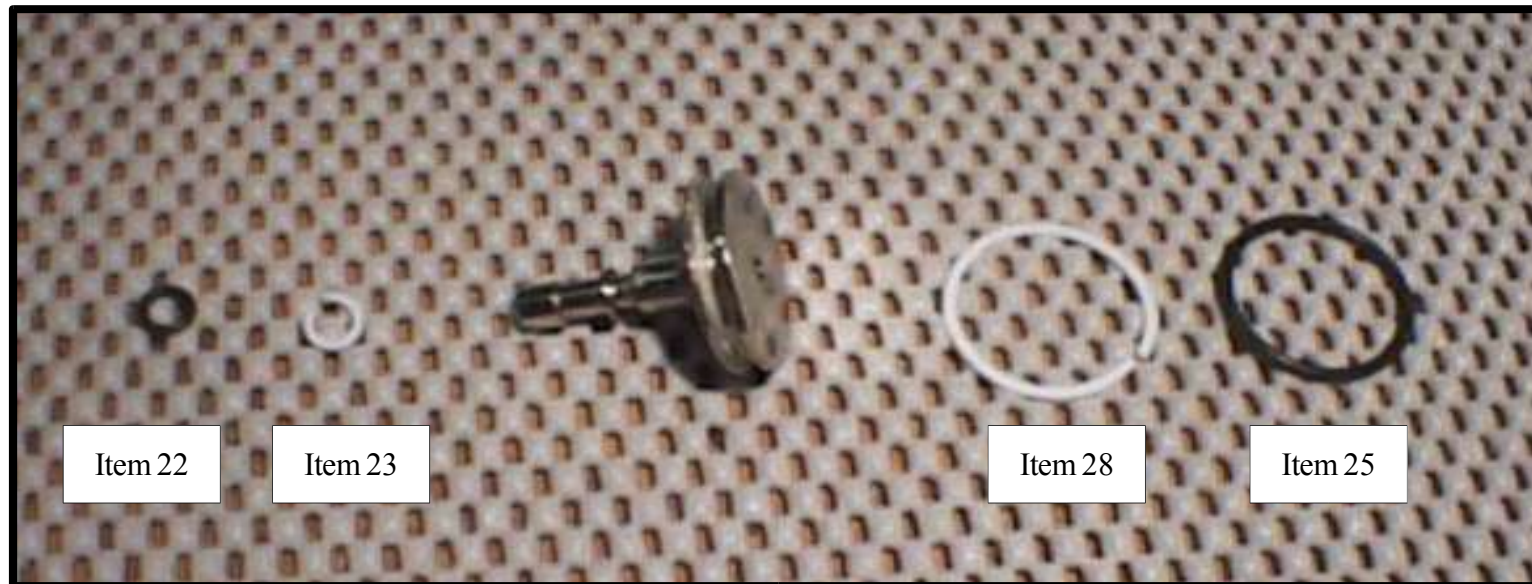

✓ Note position of o-rings to back-up rings.  
Rings are installed in order as shown.

✓ **Inspect the high pressure seat (item 21) before removal.**

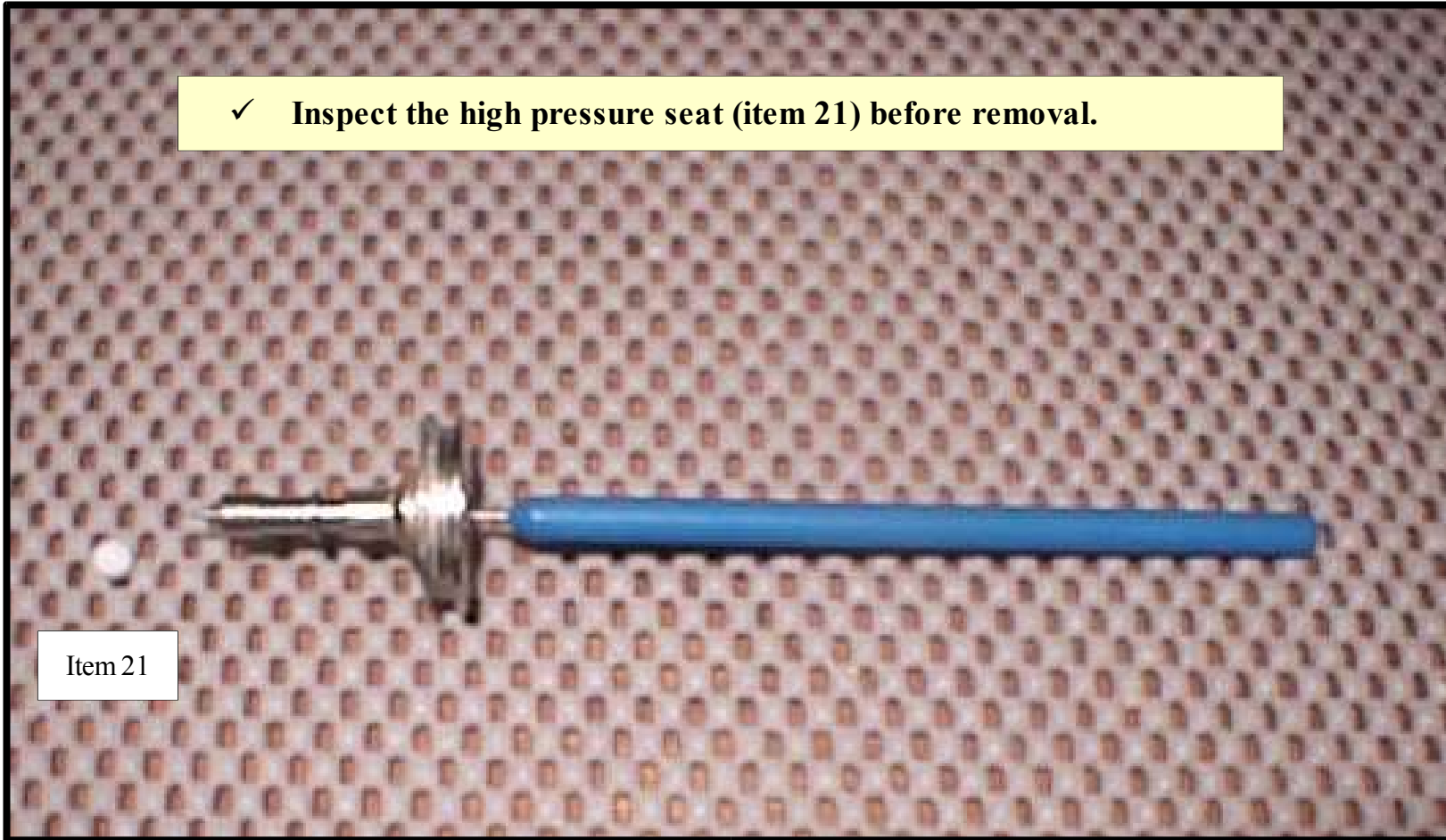

Item 21

- 15) Insert the metal end of the HP Seat Tool into the hole in the large end of the piston.**
- 16) Ensure the tip of the tool is aligned into the smaller hole under the seat. Press out the seat (item 21) and discard.**

**Using snap-ring pliers (or a small screwdriver)**

- 17) Remove the tension clip (item 6) from the inlet (yoke end) of the regulator body**
- 18) Remove the inlet filter (item 7).**

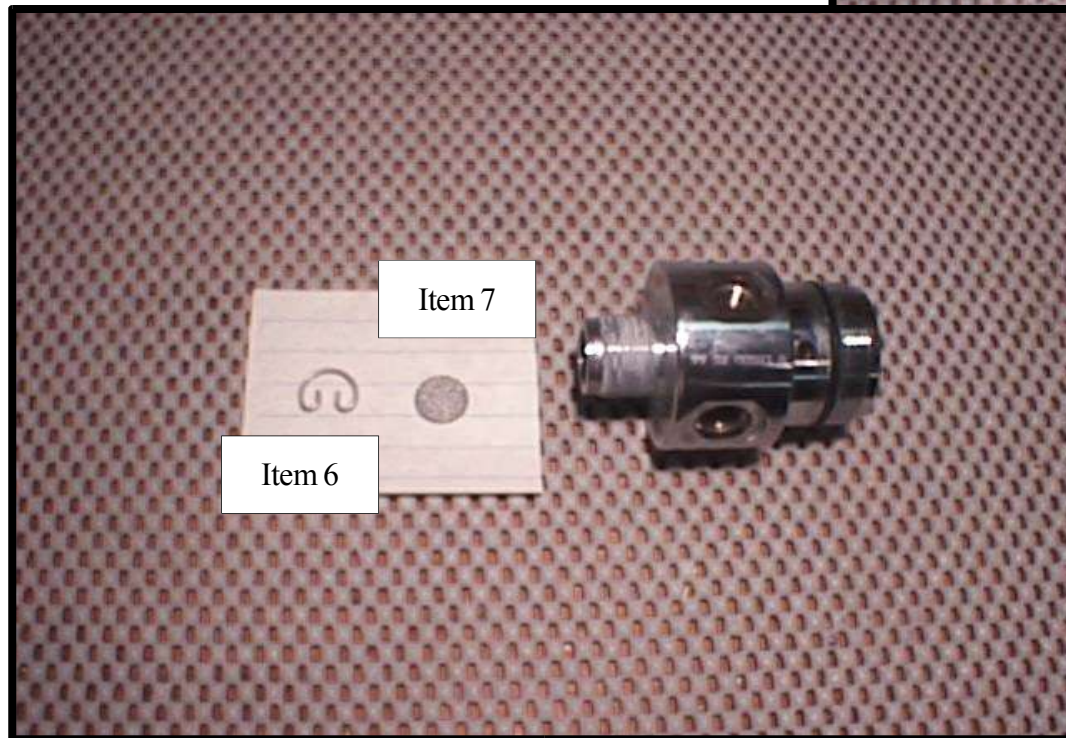

- ✓ **Inspect the filter for evidence of aluminum oxide (white), rust (red/brown), or other contamination.**
- ✓ **If contaminants are visible in the filter, make a note on the repair documents. Discard the filter after inspection.**



**19) Insert the blunt end of the HP seat tool into the end cap side of the regulator body. Gently push the orifice assembly out the inlet side of the regulator body.**



**✓ CAUTION: Use care when handling the orifice assembly to prevent damage to the delicate sealing surface. Even minor damage can cause pressure creep and decreased performance.**

- 20) Remove and discard the o-ring (item 11).
- 21) Remove the backup ring (item 12) and set aside.
- 22) Remove spring washers by sliding them off the orifice stem (item 8).



✓ Note the orientation of the spring washers (items 10)

